



Gibson House, Stanwell Village TW19 7JR

£1,200 Per Month
EPC Current Band: C

DEPOSIT ALTERNATIVE AVAILABLE

We are pleased to offer this well presented one bedroom ground floor flat which features an open plan lounge/kitchen with appliances, modern bathroom suite, communal gardens and allocated parking for one vehicle.

The property further benefits from double glazed windows and gas central heating.

Situated within Stanwell Village, the property is conveniently located close to local shops and offers easy access to Heathrow Airport and the M25 motorway.

Ideally suited to a single adult or couple.

COUNCIL TAX: Band B

HOLDING RETAINER (equivalent to one week's rental): £270



Ground Floor

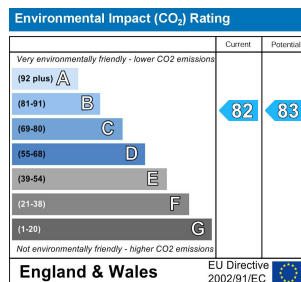
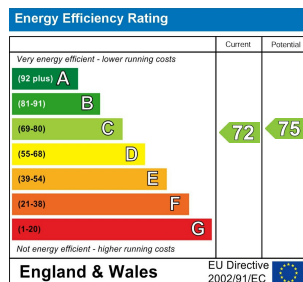
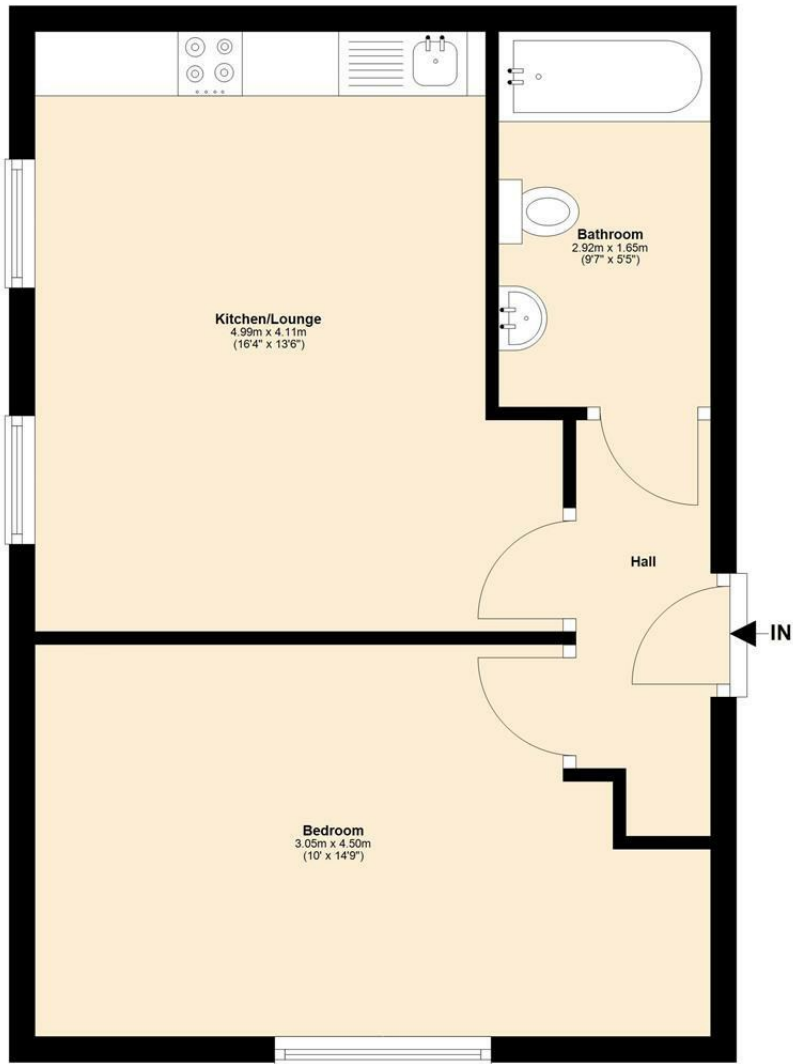

Whilst every attempt has been made to ensure the accuracy of the floor plan contained here, measurements of doors, windows, rooms and other areas are approximate and no responsibility taken for any error, omission or mis-statement. This plan is for illustration purposes only and should be used as such by any prospective purchaser or advisor. Tomkins Davis have not tested any apparatus, equipment, fixtures and fittings or services therefore cannot verify that they are in good working order or fit for purpose. Neither have we checked any legal documentation to verify the leasehold or freehold status of the property and advise any purchaser to obtain verification from their solicitor or surveyor.